



ENAPART



93 S Railroad Avenue Unit C
Bergenfield NJ 07621 USA
www.enapart.com
sales@enapart.com



Via del Canneto 35,
Borgosatollo, Brescia - Italia
www.enapart.it
vendite@enapart.it



Barbaros Mah. Ihlamur Bul. Aĝaoĝlu
My Newwork No:3/15 Ataşehir / İstanbul
www.enapart.net
satis@enapart.net



PRIVADA 10 B SUR #3908 COL.
ANZUREZ, C.P. 72530, PUEBLA, PUE
www.enapart.com.mx
sales@enapart.com.mx



Friedrich-Ebert-Anlage 36, 60325
Frankfurt am Main, Germany
www.enapart.de
anfrage@enapart.de



4 boulevard Carnot, 95400
villiers-le-bel, Paris, France
www.enapart.fr
sales@enapart.fr



65049, ОДЕСА, ВУЛИЦЯ ІВАНА
ФРАНКА, БУДИНОК 55, ПОВЕРХ 3
www.enapart.com.ua
sales@enapart.com.ua



MUNICIPIUL BUCUREȘTI, SECTOR 3,
B-DUL BASARABIA, NR.250, CORP P+5
www.enapart.ro
sales@enapart.ro



〒584-0023 大阪府富田林市若松町
東2丁目2番16号
www.enapart.co.jp
sales@enapart.co.jp



PLAZA NUESTRA SEÑORA DE LAS
NIEVES 12 ,LOCAL ,50012,ZARAGOZA
www.enapart.es
ventas@enapart.es



Складова база „Онгъл“, Склад А2, п.к.
4006, гр. Пловдив, България
www.enapart.bg
sales@enapart.bg



3 Austin Mews, High Street, Hemel
Hempstead, HP1 3AF , United Kingdom
www.enapart.co.uk
sales@enapart.co.uk

I level

Multi Level Switch

UNS-2000 Series

Technical Drawing

Formerly Series BLS 800

Dimensions in inch (mm)

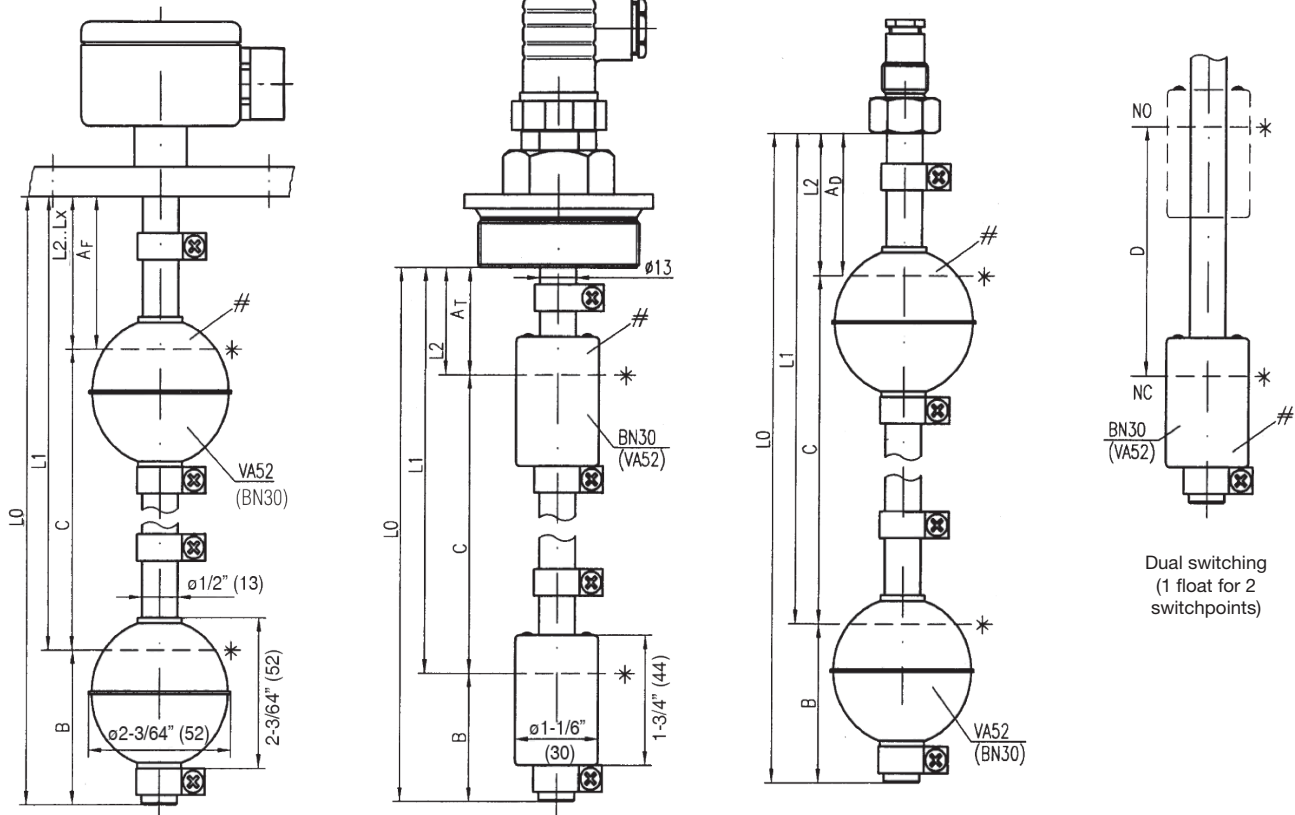

With Aluminum Junction Box and 1/2" NPT female conduit (KL6C or KL12C)

With DIN Connector (ST1)

With Cable gland (PG)

Mounting Types:

1. Length tolerance ± 3 mm
2. L0 = max. 3000 mm (118 inches)

* Immersion depth at density 1:
 VA52 = 36 ± 2 mm
 BN30 = 20 ± 2 mm

Float position:

- VA52 = NO/NC \Rightarrow see float marking
- SPDT \Rightarrow NO-function
- BN30 = NO \Rightarrow compound points at bottom
- NC \Rightarrow compound points at top
- SPDT \Rightarrow compound points at bottom

| Dimensions | Min. distances in mm | | | | | |
|------------|----------------------|----|----|----|----|----|
| | AF | AT | AD | B* | C | D |
| Float type | | | | | | |
| VA52 | 32 | 32 | 32 | 55 | 85 | 55 |
| BN30 | 40 | 40 | 40 | 39 | 77 | 55 |

*When using -DR: Dimension B + 20 mm!
 *When using -PT100: Dimension is B + 10 mm
 *When using -TPxx/2: Dimension is B + 40 mm

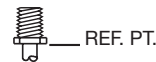

1/2" NPT

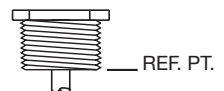

T1-1/4" or T2" NPT

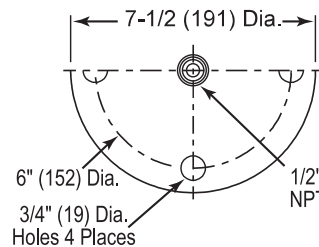

FLA5

3" 150# Flange with 1/2" NPT Male Fitting (per applicable ANSI specifications)
 Flange only available in stainless steel.

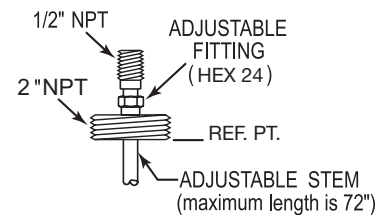

Adjustable Stem
 Only available with flange and 'T' type connections

Multi Level Switch

UNS-2000 Series

Formerly Series BLS-800

UNS-2000 Series Order Form

Check Boxes to Select Specification Requirements

Description:

UNS 2000 - _____ / _____ - _____ - _____ - _____ / _____ - _____

Product Configurator

| | | | | | | | | |
|---------|----------|-----|---------|-------|-------|----|-------|-----------------------------------|
| Example | UNS 2000 | -VA | / T2NPT | -KL6C | -VA52 | L2 | / 2.1 | -(DR)-(VV)-HT-U-PT100-TP/XX.X-Exi |
|---------|----------|-----|---------|-------|-------|----|-------|-----------------------------------|

Basic Configuration

UNS 2000 Level switches type

Check Required Specs

Material of Stem

- VA SS316
 MS Brass

Mounting Element

- 1/2NPT 1/2" NPT mounting (inside tap)
 T1-1/4NPT 1-1/4" NPT tank screw
 T2NPT 2" NPT tank screw
 FLA5 3" Blind flange (150#)

Electrical Connection¹

- ST1 Cube plug DIN 43650, 3-pin + GND
 ST2 Angle plug DIN 43651, 6-pin + GND
 KL6C Aluminum terminal box, 6 terminals with 1/2" NPT conduit
 KL12C Aluminum terminal box, 9 terminals with 1/2" NPT conduit
 PG PG-cable gland with 1 m PVC-cable
 K PVC-cable sealed, specify length at order
 KXP Explosion proof junction box with 1/2" conduit
 C 1/2" NPT male conduit (VA only)

¹ See "Combinations" section on page 1 for mounting and electrical connection options.

Float Type

| | Min. Density | Material | Form | Ø | Max. Temp. | Max. Bar |
|-------------------------------|------------------------|----------------------|----------|-----------------|---|----------|
| <input type="checkbox"/> BN30 | 0.6 g/cm ³ | NBR | Cylinder | 30 mm 1-3/16 | 212 °F (100 °C) - Oil 176 °F (80 °C) - Water | 15 |
| <input type="checkbox"/> VA52 | 0.78 g/cm ³ | Stainless steel, 316 | Ball | 52 mm 2-1/16 | 302 °F (150 °C) | 40 |

No. of Switchpoints²

L=Level, T=Temperature

- L1 1 Switchpoint @ _____ in/mm
 L2 2 Switchpoints @ _____ in/mm
 L3 3 Switchpoints @ _____ in/mm
 L4 4 Switchpoints @ _____ in/mm
 L5 5 Switchpoints @ _____ in/mm
 L6 6 Switchpoints @ _____ in/mm

See also Connection Groups in table "Max. Switchpoints"

Options, please specify when needed

- DR Damping tube
 HT High temperature silicone cable (max 6 wires), (up to +150 °C) 302°F
 U Mounting through bottom
 PT100 PT100-element
 VV Vertical adjustment
 Exi ATEX approval EEx ia
 TP 3A, 12 or 24V DC
 X Contact mode 2 (NC)
 XX Setpoint at rising in °C

Standard +122 °F / +158 °F / +194 °F (+50 °C / +70 °C / +90 °C)
Others on request

Contact Type of Float

| | Contact Mode | Contact Rating |
|--------------------------|--------------|--------------------------------|
| <input type="checkbox"/> | 1-SPST (NO) | 250 V AC / DC, 3 A, 100 VA / W |
| <input type="checkbox"/> | 2-SPST (NC) | 250 V AC / DC, 3 A, 100 VA / W |
| <input type="checkbox"/> | 3-SPDT | 140 V AC / DC 1 A, 60 VA / W |

Must specify with your orders

Check List:

- Overall stem length: L0= _____ (in/mm) (Upto 3000mm std.)
- Add dimensional position of float
- Pick wiring code:

Group 1

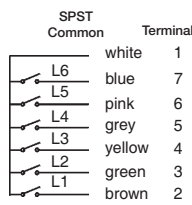

Group 2

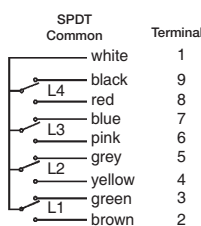

Group 3

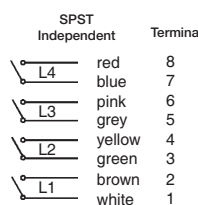

Group 4

